

YUMA COUNTY  
DEPARTMENT OF ENGINEERING  
**APPROVED FOR CONSTRUCTION**

DATE: 02/13/2025 BY: Colby E

All Material testing reports are to be submitted to YC ENG Dept/Inspector prior to proceeding with next phase throughout project.  
See Notes on C2.1

32 00 00 - Traffic Light

32 10 00 - Paving

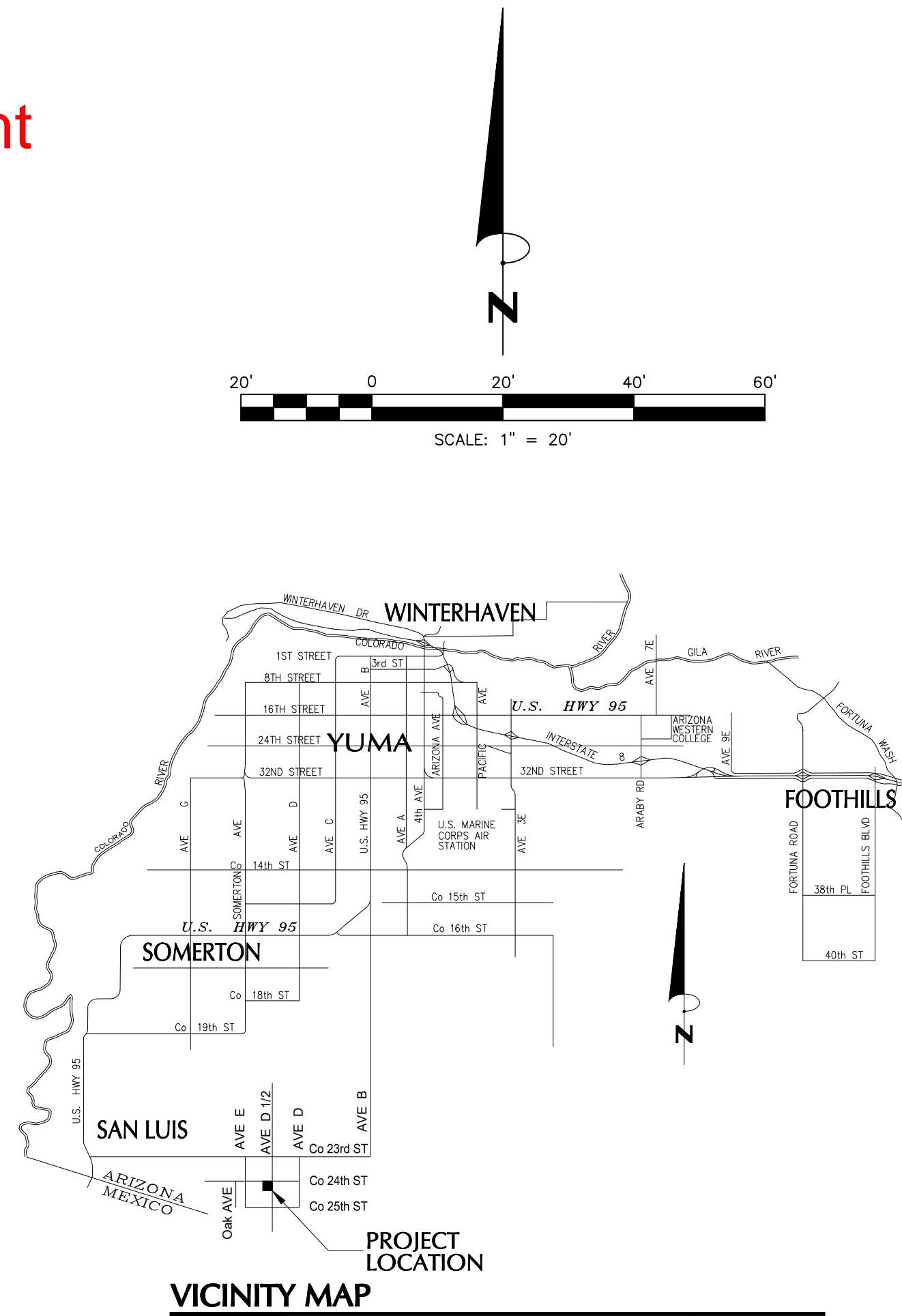
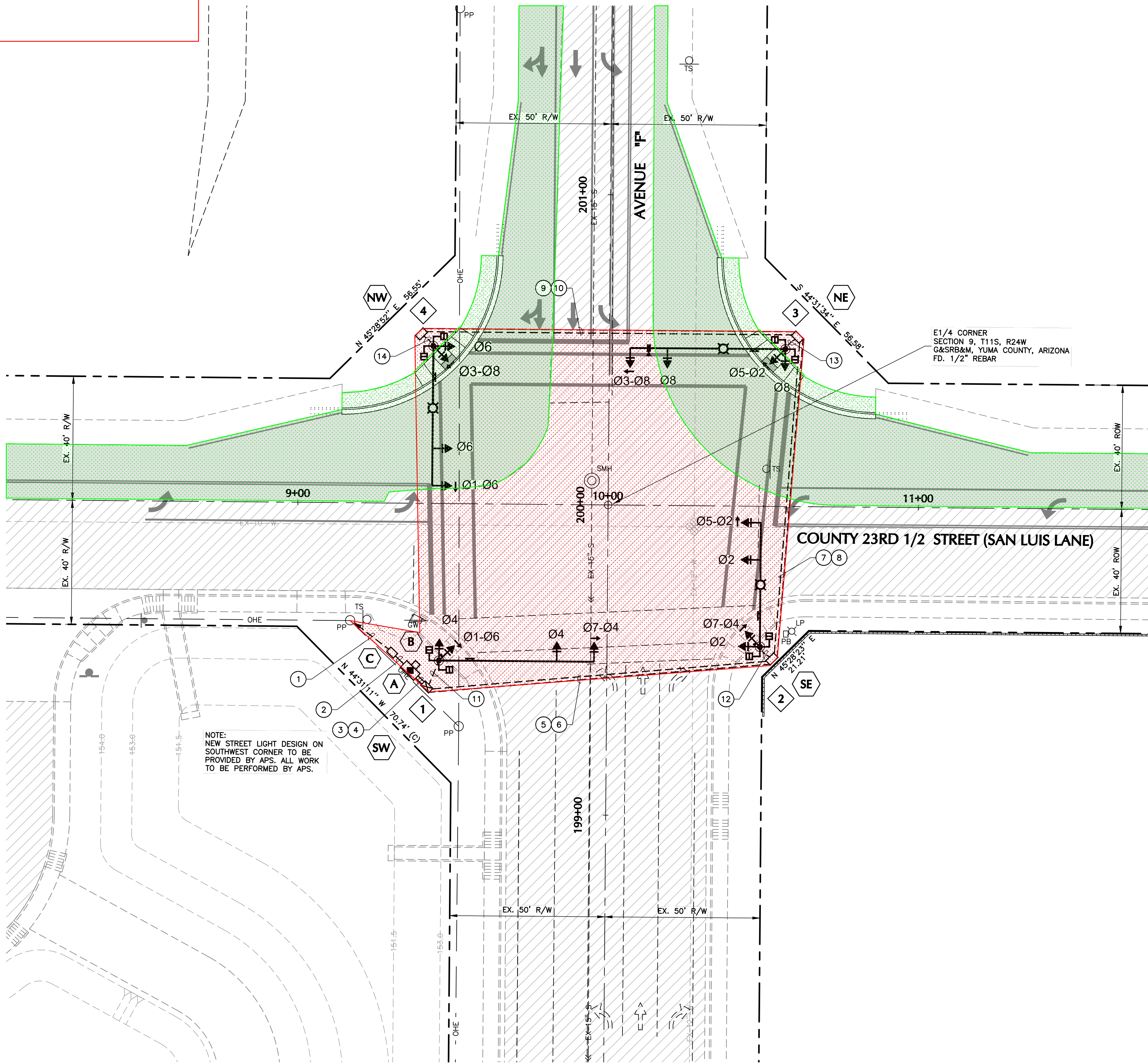

**LEGEND**

- CONDUIT
- NEW SIGNAL POLE AND MAST ARM
- NEW LUMINAIRE AND ARM
- NEW SIGNAL
- NEW SIGNAL WITH W/ DIRECTIONAL ARROW
- NEW PEDESTRIAN SIGNAL HEAD
- NEW INTERNALLY ILLUMINATED STREET NAME SIGN (ISNS)
- NEW MODEL 722 OPTICAL DETECTOR
- NEW PULLBOX
- NEW CONDUIT RUN NUMBER
- NEW POLE/CABINET DESIGNATION
- NEW CONTROLLER CABINET WITH SERVICE ENCLOSURE
- NEW PUSH BUTTON
- NEW CAMERA GRIDSMART V.I.V.T.D.S.

**NOTES:**

- AIMING OF SIGNALS MUST BE ADJUSTED AS DIRECTED BY THE ENGINEER.
- TYPE FO PULL BOXES TO HAVE EXTENSIONS.
- THE CABINET MUST BE EQUIPPED AND WIRED SO THAT THE USE OF PROTECTED/PERMISSIVE PHASING (5-SECTION SIGNAL HEADS) IN THE FUTURE WILL NOT CAUSE AN ABSENCE OF RED FAILURE TO BE REGISTERED ON THE MALFUNCTION MANAGEMENT UNIT FOR PHASES 1, 3, 5 OR 7.
- CONDUIT TO BE INSTALLED BY BORING METHOD (NO PAVEMENT REMOVAL WILL BE ALLOWED)

**UTILITY WARNING**

THE UNDERGROUND UTILITIES SHOWN HAVE BEEN LOCATED FROM THE FIELD SURVEY INFORMATION AND EXISTING DRAWINGS. THE SURVEYOR MAKES NO GUARANTEE THAT THE UNDERGROUND UTILITIES SHOWN COMPRISE ALL SUCH UTILITIES IN THE AREA, EITHER IN SERVICE OR ABANDONED. THE SURVEYOR FURTHER DOES NOT WARRANT THAT THE UNDERGROUND UTILITIES SHOWN ARE IN THE EXACT LOCATION INDICATED ALTHOUGH HE DOES CERTIFY THAT THEY ARE LOCATED AS ACCURATELY AS POSSIBLE FROM INFORMATION AVAILABLE. THE SURVEYOR HAS NOT PHYSICALLY LOCATED THE UNDERGROUND UTILITIES.



**SAN LUIS ELEMENTARY SCHOOL**  
SOMERTON SCHOOL DISTRICT 11  
CO. 23RD 1/2 STREET (SAN LUIS LANE) & AVENUE 'F'  
SAN LUIS, ARIZONA  
**TRAFFIC SIGNAL**



DATE: JUNE 2024  
DESIGNED BY: KD/SM  
DRAWN BY: SM  
CHECKED BY: KD  
SURVEYED BY: MAC  
PROJECT NO.: 21285  
SHEET

C1.1